



The Model EBD-435SP offers a fully integrated CNC operation with accuracy and repeatability. The features of this DrillMate allow interactive programming with Real-time Path Display for reliability on program management.

- ✓ World's Fastest Automatic Electrode Changer
- ✓ Optional Submerged Work Tank
- ✓ Touch Screen Operator Control
- ✓ Windows Operating System
- ✓ Granite X & Y Axis Column
- ✓ Multiple Tap Transformer
- ✓ Servo Driven Linear Axis
- ✓ Optional Power Booster
- ✓ Programmable W Axis
- ✓ A & B Axis Interface



## MACHINE SPECIFICATIONS

### Model EBD-435SP

Table Travel (X-Y)	15.75" x 13.18"
W Axis Stroke	10.63"
Z Axis Stroke	9.84"
Max Work Piece Size (WxDxH)	28.35" x 22.83" x 11.22"
Loading Weight	770 lbs.
Max. Workpiece Height	11.2"



Automatic Electrode Changer and Tube Feeder

## POWER SUPPLY/FLUID UNIT

Voltage Selections	2 Steps
Input Voltage	208/220/240/480 4kVA
Max Current	40 Amp
Dielectric Fluid	Water/Oil
Fluid Capacity	26.4 Gallons (Standard)
Deionize System	Standard

## CONTROL

Input System	USB/LAN/MDI
Display	15" LCD Touch Screen
Position Command System	Incremental/Absolute
Operating System	Microsoft Windows 7~10

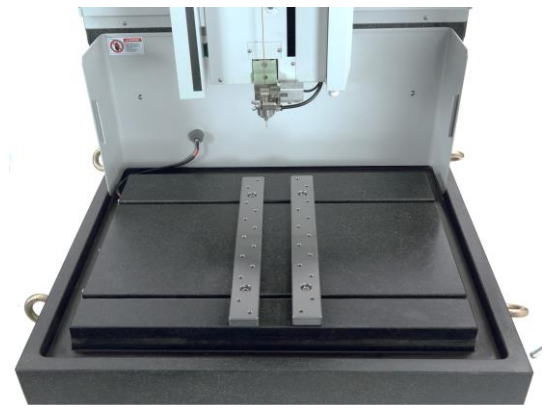

Granite Worktable with T-Slots

## INSTALLATION DIMENSIONS

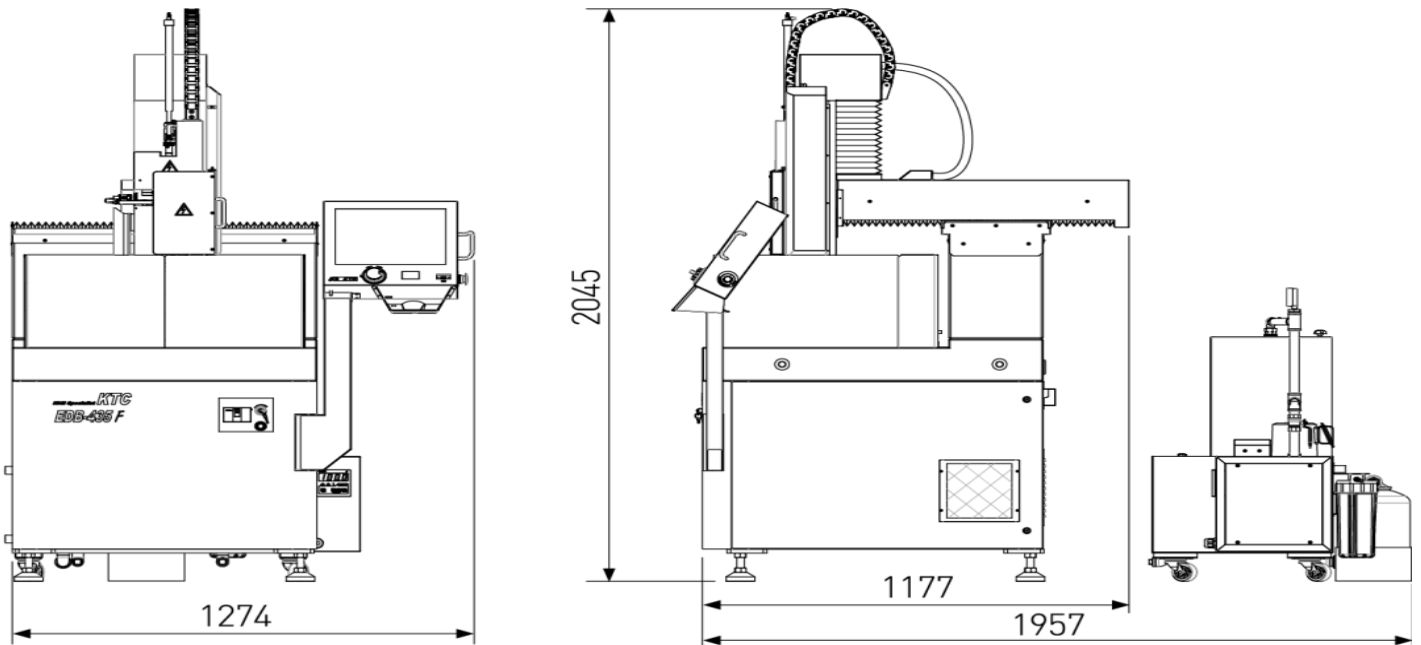

Distributed by PERSEO-ERIE, Inc.

2230 West 23rd Street • Erie, PA, 16506814/452-4658 • Fax.814/456-8447 • TollFree800/900-9117 • Website:www.edmdrillmate.com • Email:office@edmdrillmate.com